

**For an
unforgettable
key experience.**

The complete KfV door hardware range

Looking forward 360°.

As a German company with over 100 years of experience we are advancing the future of room comfort – with a holistic approach and innovative ideas to design the best solutions for our customers. In doing so we combine the highest demands in use with precisely matching services along the entire planning and production process and also take responsibility for how room comfort is created sustainably.



Use

Where technology meets comfort.

We focus on people and their needs and create rooms for comfortable feeling with our well thought out products. Rooms which are comfortable, energy efficient and ready for the future and also take every generation into account. Our entrance door solutions ensure that security and comfort are not mutually exclusive, but complement each other perfectly. By automatically closing doors securely as they are locked and granting access only to authorized persons.

Services

Conceived from practical application. Produced for practical application.

Because a good product is more than just its function, we take care that our solutions always make the everyday work of our partners appreciably easier too – from planning to production to installation on site.

For example, with our modular system KfV ONE simplifies the ordering and fabrication of multi-point locks: with uniform routing template, a high degree of pre-assembly and freely combinable product families.

This is how we
create rooms with a future.
360° room comfort

Sustainability

Experience, bearing responsibility.

In respecting with the tradition of a fourth generation family led company we act sustainably and responsibly. To reduce our ecological footprint we are therefore continually evaluating our strict climate protection roadmap to be climate neutral in accordance with Scope 1 and 2 by 2028. To do this we are producing our solutions to be not only resource efficient, but also aligning them in detail consistently on sustainability – for rooms and living spaces fit for the future.

One example: our particularly durable multi-point locks, which are always reliably tight and secure thanks to automatic self-adjustment.



KFV door hardware

Overview

06 Multi-point locks

Lever-operated	10
Key-operated	12
Accessories key-operated	14
Independent	16
Automatic	18
Electromechanical	22
Access control	24
Networking with third-party systems	26
Plug & Play	30
Repair	32

34 Locks

Mortise locks and magnetic locks	36
Latch and deadbolt locks	38
Special locks	40

42 Emergency exits and panic locks

Solutions for escape doors and emergency exit doors	44
---	----

46 Frame parts

Individual striker plates and locking rails	48
Double-sash doors	49
Accessories	50



KFV multi-point locks

Simply multiple benefits: more productivity for you, more variety for your customers.

More diversity, less expense.

If you're looking for multi-point locks, you will find a large choice of versions at KFV. Whether these are for timber, PVC or aluminium profiles, key-operated or handle-operated, automatic or mechanical locking, for single or double-leaf doors or for three-meter-high elements KFV multi-point locks, including the frame parts, are perfectly coordinated locking systems, which fulfil maximum security and comfort requirements. In the process, robust locking elements as for instance comfort mushroom cams, steel round bolts or hook bolts are employed. Our products are certified in accordance with a number of standards, including DIN, CE, VdS and SKG. Furthermore, our products come complete with quality seals such as "K-EINBRUCH" from the German criminal investigation advisory bureau to prevent security-related incidents.

Thanks to continuous development, we manage to retain our quality and innovative edge when it comes to multi-point locks. With our modular system KFV ONE, the proven KFV system benefits have been subjected to consistent further development and the boundaries of modularity have been completely newly defined. Therefore, fabricators are able to configure a versatile variant spectrum, distinguished by the maximum reduction of essential components, lean warehousing and easy ordering. Simple assembly processes are maintained by the uniform milling and screwing positions which allow cross-series use.

KFV multi-point locks

The right solution for any situation.

Our perfectly coordinated complete range of multi-point locks including the frame parts provides you with a tailor-made and highly efficient solution for every situation. Our multi-point locks are intelligent modular systems that make your work from fabrication to installation considerably easier. Uniform routing templates for different types of lock and freely combinable product families make prefabrication more efficient, service faster and reduce warehousing.

- Comprehensive product range in a freely combinable modular system: great range of versions and reduced warehousing
- Clever modular dimension for identical routing templates
- Consistently high-quality materials and precise fabrication
- high burglar resistance up to RC4
- Excellent thermal insulation and the best sealing possible
- Variety of backsets and PZ dimensions available

Production benefits

- Quick and easy production and installation due to identical routing templates for all auxiliary lock cases
- Efficient prefabrication possible
- DIN direction can be adjusted on site, smooth switch-over process
- Reduction of error rate thanks to simplified sequences





Lever-operated multi-point locks

Locking and release of the door via the lever handle.

Lever-operated KfV multi-point locks require a door handle on the inside and outside. If it is pulled up, the locking elements are brought into the locking position and pull the door into the seal. The lever handle then springs back to its starting position and can be unlocked without a key simply by pushing the handle down again. If the door is to remain securely locked, the lever function can be blocked on both sides by turning the key once and simultaneously locking the main lock. Deblocking is also carried out by turning the key.

AS 4100
Multi-point lock with four self-adjusting comfort mushroom cams with continuous height adjustment.



Planning and production

Locking type	Locking part with 4 comfort mushroom cams
Door height can be extended	up to 3,000 mm
Product certification	SKG, QM 342
Intended for resistance class in accordance with EN 1627–1630	RC1
Latch changeover (DIN right/left adjustable)	⊙
Locking rail with adjustment option +/- 2.5 mm	—
Individual striker plates with adjustment option +/- 2.5 mm	—
Secondary sash lock bolt for double sash entrance doors	⊙

Options for greater room comfort

Day latch	⊙
Bolt switch contact control system	—
Concealed axxent door hinge	⊙

Key-operated multi-point locks

Locking and release of the door via the cylinder lock.

With key-operated KfV multi-point locks all the locking elements in the main lock and in the auxiliary lock cases can be operated by a double turn of the key in the main lock. This way maximum security demands and comfort requirements are fulfilled with ease. With our modular system KfV ONE, the proven KfV system benefits have been subjected to consistent further . This new generation will allow fabricators to configure a wide range of variants in the future, characterised by explicitly lean warehousing and easy ordering as a result of the maximum reduction of necessary components.

BS 2100
Multi-point lock with four self-adjusting comfort mushroom cams with continuous height adjustment.



Planning and production

Locking type	Locking part with 4 comfort mushroom cams
Door height can be extended	up to 3,000 mm
Product certification	SKG, QM 342
Intended for resistance class in accordance with EN 1627–1630	RC1
Classification according to prEN 15685:2019	3S500C3011
Latch changeover (DIN right/left adjustable)	⊙
Locking rail with adjustment option +/- 2.5 mm	—
Individual striker plates with adjustment option +/- 2.5 mm	—
Secondary sash lock bolt for double sash entrance doors	⊙

Options for greater room comfort

Soft lock latch	—
Safety lock	—
Day latch	⊙
Bolt switch contact control system	—
Concealed axxent door hinge	⊙

BS 2300

Multi-point lock with two conical steel round bolts.

**BS 2500**

With two conical hook bolts locking from bottom to top.

**BS 2600**

The combination of two steel round bolts and two hook bolts for maximum security.



Locking part with 2 round bolts

up to 3,000 mm

QM 342, SKG,
K-EINBRUCH seal of approval

up to RC2

3S500C4001



Locking part with 2 hook bolts

up to 3,000 mm

QM 342, QM 314,
K-EINBRUCH seal of approval

up to RC3

3S500C4041



Locking part with round bolt - hook bolt combination

up to 3,000 mm

QM 342, QM 314, A2P,
K-EINBRUCH seal of approval

up to RC4

3S500C4041



Accessories for KfV multi-point locks

For individual security and comfort requirements.

Soft lock latch

For whisper-quiet closing comfort without maintenance expenditure.

Manual closing comfort isn't just a question of smooth operation; it's also about the acoustics. Due to its abrasion-resistant PVC coating, the soft lock latch reduces the closing noise to a quiet clicking. Any maintenance expenditure is omitted because it needn't be greased.



Production benefits

- The latch can be easily replaced without having to open the gear box
- Can be used DIN right or DIN left
- Maintenance-free since the latch does not need to be greased

Swing door roller latch

The comfortable solution for highly frequented doors.

Use of the swing door roller latch means that highly frequented doors can be conveniently opened from the outside by pressing the push plate. It is therefore ideally suitable for shop entrance doors and for main entrances of public buildings.



Production benefits

- Compensation of airgap tolerances due to adjustment screw in the swing door roller latch with large 5-mm adjustment range
- AS variants available preassembled from factory
- Retrofittable for BS variants

Swiss round cylinder

A bundle of assembly benefits.

The well-conceived design allows the installation of complete Swiss round cylinders without having to lower the multi-point locks. All time-intensive work steps for conventional solutions prior to the insertion of the Swiss round cylinder are a thing of the past – from the removal of the pre-assembled multi-point lock gear, the potential removal of a pre-assembled handle set to the lifting and screwing of all components once again.



Production benefits

- Assembly without lowering the multi-point lock
- Significant time-savings
- Low 17.5 mm rear backset

Extension piece

For the extension of key-operated multi-point locks.

The extension piece is suitable for high entrance doors and available in four different versions: for KfV multi-point locks with round bolts, hook bolts, round bolt - hook bolt combinations or comfort mushroom cams.



Production benefits

- For the extension of key-operated multi-point locks BS 2300, BS 2500 and BS 2600
- Length: 500 mm
- Seat of the additional lock in two size variants
- The extension set contains: connection driving rod for suspension in the auxiliary lock case

Safety lock

Additional protection when opening the door due to blocking clip.

The opening width of the door can be restricted to a secured gap at any time with the safety lock. The locking lever, integrated in the rebate, can be easily activated with a thumb turn. Depending on the version, unlocking from the outside using the main lock is possible for authorised persons at any time.



Production benefits

- Can be used DIN right and DIN left
- The swivel knob position is adapted to the backset
- Retrofit possible on all multi-point locks AS/BS 2300, 2500 and 2600 with hole group "T0"
- Available preassembled for multi-point lock AS 2750
- Sprung index pin with 12.5 mm deadbolt to compensate for airgap tolerances

Additional deadbolt lock

Upgrade your security.

The additional bolt can be operated separately from the inside or from the outside using a key and is designed for profile cylinders.



Production benefits

- Designed for profile cylinder
- 15 mm bolt projection
- Available backset dimensions: 35, 40, 45, 50, 55 or 65 mm backset
- Subsequent installation is possible on all AS/BS 2300, 2500, 2600 multi-point locks with "T0" hole group

AS 2750

With triple self-closing function via the main lock and auxiliary lock latches.

The AS 2750 three-latch lock is equipped with the main lock latch as well as two sprung soft lock latches in order to fix the door sash three times in the frame simply by closing it. This gives long-term protection against door warping and against unauthorised entry attempts, even when unlocked, by pushing the main lock latch back. After locking with the key, the hook bolt-latch combinations ensure burglar resistance up to RC3. The powerful but smooth-running gear ensures excellent sealing, thermal protection and sound insulation even in case of strong pressure or suction load.

Planning and production

Locking type	3-latch locking part with 2 hook bolts
Door height can be extended	up to 2,400 mm
Product certification	QM 342, SKG, K-EINBRUCH seal of approval
Intended for resistance class in accordance with EN 1627-1630	up to RC3
Classification according to DIN 18251-3:2002	3
Classification according to prEN 15685:2019	in preparation DIN EN 15685:2025
Latch changeover (DIN right/left adjustable)	⊙
Locking rail with adjustment option +/- 2.5 mm	⊙
Individual striker plates with adjustment option +/- 2.5 mm	⊙
Secondary sash lock bolt for double sash entrance doors	⊙

Options for greater room comfort

Soft lock latch	⊙
Safety lock	⊙
Daytime release	—
Day latch	⊙
Bolt switch contact control system	⊙
Access control systems	—
Concealed axxent door hinge	⊙



- Double-acting hook and latch lock combination offers burglary protection up to class RC3
- two additional soft-lock latches for long-term protection against door warping
- more security against opening attempts when unlocked via the main lock latch, for example with a bank card
- Release of the door in combination with 3 E-openers possible
- Gear ratio designed for powerful door tightening
- Optimal seal and thermal and sound insulation
- suitable for residential front doors, exterior doors and the commercial sector

Production benefits

- DIN direction can be adjusted, smooth switch-over process
- Standard locking rail can be used
- Release of the door in combination with three E-openers is possible
- Optional with preassembled safety lock T2
- Suitable for exterior doors, residential front doors and the commercial sector

Self-blocking function via the latches.

With triple self-blocking function due to spring-loaded soft lock latches.



BS 3700, BS 3700 C

Automatic multi-point locking systems with integrated self-adjustment.

The BS 3700 is the first multi-point lock that simply ignores critical installation locations or thermal influences: its intelligent design and matching frame parts eliminate the need for on-site readjustment – even after several years of heavy use of the door. The new locking elements fix the door panel securely in the frame at all times, even if the door is warped.

The BS 3700 C version with comfort function is suitable for doors in apartment buildings, which do not need to fulfil the requirements of an escape or panic door (EN 179/EN 1125). It provides the possibility to leave the building quickly and safely at any time without a key, even if the door is locked. The omission of the blocking function means that the door can be opened via the lever handle from the inside at any time. The locking part is nevertheless released automatically and is self-adjusting via two locking elements and two hook bolts each in the auxiliary lock cases. The main lock bolt is extended at the same time.

Planning and production

BS 3700

BS 3700 C: Specially for apartment buildings

Locking type	Self-adjusting automatic locking mechanism with two locking elements, two hook bolts and main lock bolt
Door height can be extended	up to 3,000 mm
Product certification	SKG, QM 342
Intended for resistance class in accordance with EN 1627–1630	intended until RC4
Classification according to DIN 18251-3:2002	—
Classification according to prEN 15685:2019	3S500C4040
Latch changeover (DIN right/left adjustable)	⊙
Locking rail with F-backing including auto-adjustment	⊙
Individual striker plates with F-backing including auto-adjustment	⊙
Secondary sash lock bolt for double sash entrance doors	⊙

Options for greater room comfort

Soft lock latch	⊙
Safety lock preassembled at the factory	⊙
Retrofittable daytime release	⊙
Day latch	⊙
Bolt switch contact control system	in preparation Q4/2025
Access control systems	with A-opener, EN 14846 (features according to EN 1627)
Concealed axxent door hinge	⊙



- No need to readjust on-site
- All locking elements run smoothly at all times
- Automatic 20 mm projection of all locking elements with a backset of as little as 35 mm
- Child-proof lock activated by disabling the door handle using the cylinder lock
- Compliant with DIN EN 15685
- Tested and classified for 200,000 cycles with doors weighing 200 kg

Production benefits

- Easy to adjust the DIN direction using the main lock latch
- Automatic trigger latch with self-adjustment of the DIN direction
- Identical milling dimensions and fastening holes as in KfV ONE multi-point locks
- BS 3700 C: No special frame parts required, also equipped with main lock bolt



BS 3700



BS 3700 C

1 Automatic trigger latch

"C" stamp for identification



- 3 Backwards pressure protection device
- 2 Locking element
- 4 F-backing with run-up chamfer

To ensure the door locks reliably at all times, we have installed the automatic trigger latch ❶ in the main lock. This ensures that the door always closes perfectly, even if the door leaf is warped. The automatic 20 mm projection of the hook bolts and the newly designed main lock bolt ensures genuine three-point locking – with a backset of as little as 35 mm thanks to the new geometry.

The BS 3700 always guides the locking elements securely into the frame. If the locking elements ❷ do not reach their end position due to tolerances when moving into the frame parts, they are still locked and held in position by the patented backwards pressure protection device ❸. As a result, the door leaf is fixed in the optimum position and all locking elements are guaranteed to operate freely all the way to the end position. That's ingenious self-adjustment. Replacing existing KfV multi-point locks is also incredibly simple thanks to standardised modular dimensions. In the frame part, the Q-adjustment is simply replaced with the F-backing ❹.

Accessories for BS 3700, BS 3700 C

Individual solutions for individual requirements.

1

Daytime release TA

Leave the house without a key.

Practical for all everyday situations when you want to leave the building briefly without a key: simply deactivate the automatic function using the daytime release slider and release the main lock latch on the frame part. The daytime release can also be retrofitted efficiently before the BS 3700 is installed in the door leaf: slide the daytime release in from the front and simply fix in place at the side with a screw.



Production benefits

- Can be retrofitted by inserting front and side fixture with a screw
- Use with the KfV day latch or the E-opener in the frame part

2

BS 3700: safety lock T3/T4

Extra protection when opening the door.

To allow selective control at the front door, the opening width of the door can be restricted to a secured gap at any time. The safety catch integrated in the rebate can be activated and deactivated easily from the inside with the safety lock using the swivel knob. The T4 model, which comes pre-installed, allows authorised individuals to unlock the door at any time from the outside using the main lock.



Production benefits

- Can be used DIN right or DIN left
- The thumb turn position is adapted to the backset
- Sprung index pin with 12.5 mm deadbolt to compensate for airgap tolerances

4

2

1

3

3

A-opener drive unit

the easy way to open doors.

Added convenience for front doors. Not only does the door lock automatically, it also unlocks electromechanically thanks to the motor, without the need for a key. Perfect for those seeking greater convenience, barrier-free living and practical options for opening doors, including in apartment blocks. To make the process even easier when unlocking your door, it can also be combined with SIEGENIA's digital access control systems, which feature an intelligent plug & play solution for easy installation. Alternatively, existing third-party analogue systems can also be connected via an IO module.

**Production benefits**

- Easy installation
- Connection to existing third-party systems is possible
- Can be combined with the digital SIEGENIA access control systems: fingerprint scanner, keypad, transponder and with access control systems from other manufacturers

4

BV 1700 extension piece

A striking look.

Large doors are on trend. Which is why we make it possible to extend the BS 3700 by adding extension pieces, enabling door heights of up to 3 metres. For impressive entrances that don't compromise on security.

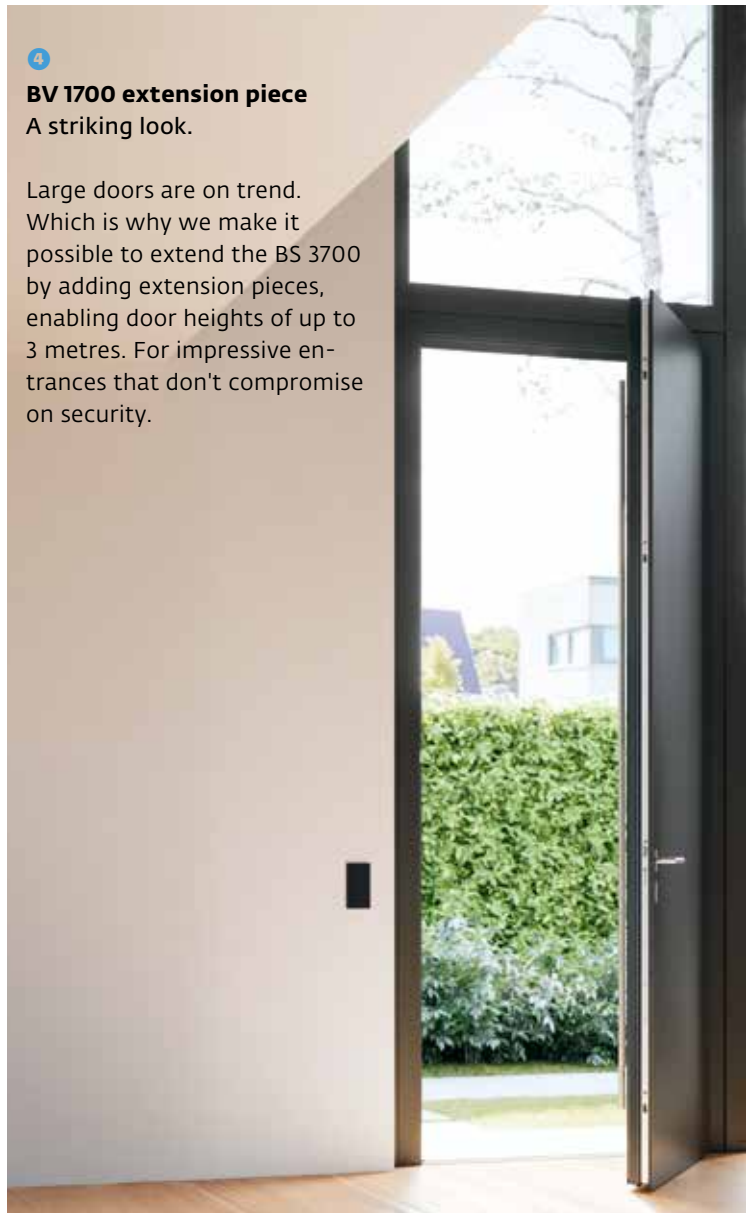
**Production benefits**

- Up to 3 m door height
- Standard multi-point lock can be extended, no special solutions
- different surfaces: galvanised, stainless steel, RAL 9007, 9005

AS 2600 GENIUS

Multi-point lock for electromechanical locking and unlocking.

GENIUS combines the security of a mechanical multi-point lock with the comfort of state-of-the-art electronics. The 2.2 version is equipped with integrated control electronics and a powerful gear motor. This quickly and quietly locks and unlocks both the round bolt-hook bolt combination in the auxiliary lock case and the main lock bolt, and also ensures maximum sealing.

Depending on the version, the GENIUS can be combined optimally with access control systems and many other uses. Even connection to existing third-party systems is possible thanks to the innovative IO modules. This offers you unlimited options in private and commercial property. In combination with motorised door drives, GENIUS can open and close doors completely: for barrier-free living, for example.

Planning and production

Locking type	Electromechanical locking part with round bolt-hook bolt combination
Door height can be extended	Up to 3,000 mm
Product certification	QM 342, SKG, EN 14846 (features according to EN 1627)
Intended for resistance class in accordance with EN 1627-1630*	up to RC 4
Classification according to DIN 18251-3:2002	3
Latch changeover (DIN right/left adjustable)	⊙
Locking rail with adjustment option +/- 2.5 mm	⊙
Individual striker plates with adjustment option +/- 2.5 mm	⊙
Secondary sash lock bolt for double sash entrance doors	⊙

Options for greater room comfort

Soft lock latch	⊙
Day latch	⊙
Bolt switch contact control system	⊙
Access control systems	⊙
Concealed axxent door hinge	⊙

* For GENIUS with comfort function (CA or CB), the inside lever handle must be protected against manipulation from the outside

Production benefits

- The same size variants and identical frame parts as in KVV standard multi-point locks
- Only one additional milling groove for the GENIUS motor
- Identical milling dimensions of main lock and secondary lock as in BS multi-point locks
- Narrow installation width of just 16 mm and installation depth of as little as 52.5 mm
- Ultra-easy ordering, installation and commissioning due to optional plug & play solutions
- Menu navigation and status messaging in installed state by colour LEDs and/or SIEGENIA Comfort app
- With SI-BUS interface for simple, space-saving direct installation without separate control unit and power supply
- Safety function: Continuous condition monitoring because uninterrupted in the active operating state
- Connection to existing third-party systems is possible
- Can be combined with the digital SIEGENIA access control systems: fingerprint scanner, keypad, transponder and with access control systems from other manufacturers



GENIUS uses electromechanical functions to open and close the door. Control is also possible via the digital SIEGENIA access control systems.



The GENIUS variants

GENIUS EA

With integrated control electronics and electronically controlled gear motor. Can be combined with the digital SIEGENIA access control systems and with systems from other manufacturers.

GENIUS EB

Compared to GENIUS EA, this system can also be combined with external systems such as timers, motorised door drives, or alarm systems.

GENIUS CA/CB

Compared with GENIUS EA/EB, additionally equipped with the "Comfort" quick-opening mechanism for quick mechanical unlocking from the inside using the lever handle.



Access control systems

More control and comfort due to intelligent doors.

Access control systems

Innovative ease of use with future-proof SI-BUS technology.

Our digital access control systems combine clever comfort functions with an elegant appearance and the extremely easy fabrication. Due to the SI-BUS interface, all three systems can communicate directly with the drive without an additional control unit. This digitalisation facilitates integration into smart living concepts and allows for future system extensions.

This leaves all options open. Further networking can either be wired via the SI BUS or wireless using Wi-Fi. The complete SI-BUS is secured with 128 Bit AES encryption.



Fingerprint scanner

Sensor with touch ID: just put your finger on it.



Keypad

Equipped with a single-use and holiday PIN function.



Transponder

Supports RFID cards with state-of-the-art encryption and maximum data security.

Benefits

- Modern, uniform design
- Covers available in black, signal grey or stainless steel look
- With Wi-Fi and Bluetooth chip as standard
- Control via the SIEGENIA Comfort app is possible
- Online remote access, timer and user administration
- 128 Bit AES encryption and access log
- Administration of up to 200 users or 800 features*
- One-time users and periodic users
- Optional keyless function
- Connection to existing third-party systems is possible



The colour-adjustable LED lighting enables custom colour matching to the front door. The brightness can be controlled manually or automatically via the light sensor.



* max. number of users is dependent on the type of drives used (A-opener / GENIUS A or B)

IO module, IO module smart

Connecting external products and applications with SIEGENIA devices and the SIEGENIA Comfort app.

The external devices and applications from a wide range of manufacturers can be flexibly connected to SIEGENIA with the IO modules – to integrate SIEGENIA solutions into third-party systems or to integrate third-party drives into the SIEGENIA world. With a SIEGENIA access control system, you can operate not only a multi-point lock, but also a garage door drive. Or close the roller shutters immediately after the locking of a window drive via the SIEGENIA Comfort app. For devices without their own WIFI function, the IO module smart also delivers a solution with integrated WIFI chip.

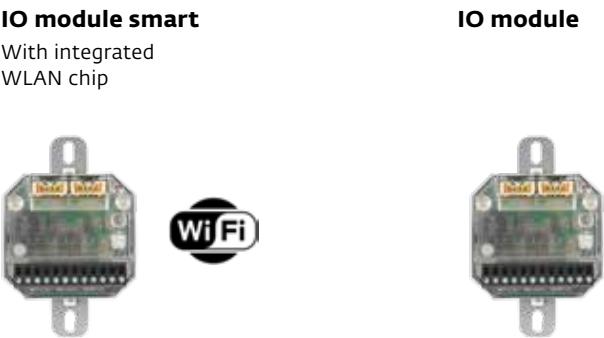

Planning and production

WIFI radio frequency	802.11 b/g/n, 2.4 GHz, 150 MBps	–
Operating voltage	19 V DC to 32 V DC	19 V DC to 32 V DC
Power consumption	1.2 W	1.2 W
Switching capacity of outputs	< 1000 mA	< 1000 mA
Switching voltage of outputs	24 V C	24 V C
SI-BUS interface	⊙	⊙
Encryption	AES 128 Bit	AES 128 Bit
Number of inputs	2	2
Number of outputs	3	3
Operating temperature range	0° C to 45° C	0° C to 45° C
IP rating	IP20	IP20
Protection class	III	III

Installation

- Compact design for on-wall or in-wall mounting
- Installation in standard cavity wall boxes and flush-mounted boxes

Functions

- Two SI BUS interfaces for digital, encrypted communication
- Two potential-free inputs
- Three potential-free outputs
- Operation and administration with the SIEGENIA Comfort app is possible: via the WIFI chip in the IO module or via a connected SIEGENIA access control system

Two SI-BUS interfaces

Enable feedback of the device and command status as well as the execution of system updates for complete digital communication in the smart SIEGENIA world.



Two potential-free inputs

Control by third-party signal transmitters, for example, intercom systems, clock timers or smart home switch actuators

Three potential-free outputs

Control of third-party multi-point locks, revolving door/garage door drives or feedback to the burglar alarm system etc. Freely selectable and configurable feedback to overriding systems



IO module, IO module smart

For universal control and system extension.

IO module

Connect third-party systems with SIEGENIA motors.

The IO module enables the connection of SIEGENIA solutions with existing third-party systems, such as intercom systems. This applies to the SIEGENIA motors for entrance doors. Whether it's detached houses or apartment buildings, hotels or schools, hospitals or office buildings: with GENIUS or the A-opener motor and an IO module, you automatically have more options in every entrance area.

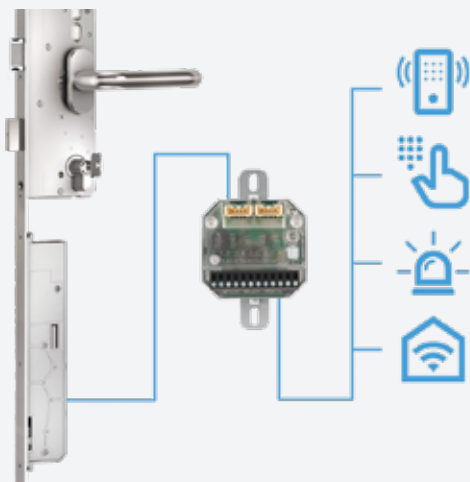

IO module

Connect SIEGENIA access control systems with third-party motors.

With SIEGENIA access control systems, garage door, roller door and motorised door drives or existing multi-point locks can also be controlled. This works using the SIEGENIA IO module, which acts as an interface to flexibly connect drives from other producers with the access control systems.

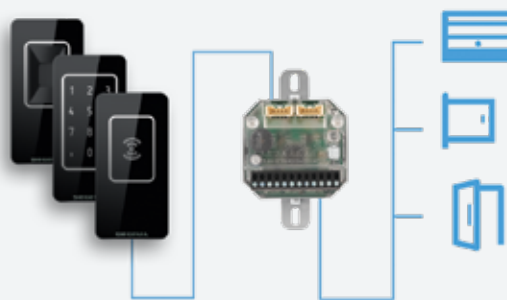

IO module smart

Operate electromechanical multi-point locks via the SIEGENIA Comfort app.

The IO module can additionally communicate via Wi-Fi. As a result, the GENIUS multi-point lock, the A-opener motor and the DRIVE axxent DK and DRIVE CL tilt-locking drives can be controlled and monitored using the SIEGENIA Comfort app.



IO module smart

Operate third-party drives with the SIEGENIA Comfort app.

The IO module smart provides a universal interface to integrate third-party drives into the smart SIEGENIA world. With the integrated Wi-Fi chip, devices without their own Wi-Fi capability can be quickly and easily integrated into the SIEGENIA Comfort app.

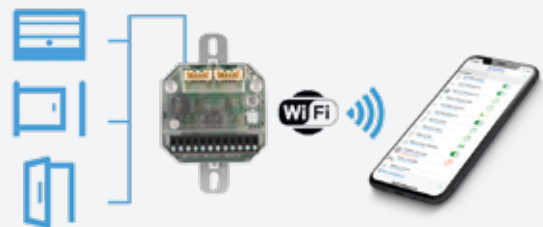

Clever Plug & Play solutions

For easy ordering and quick set-up.

Plug & Play solutions

Individual Plug & Play solutions: simply more efficiency.

Simplified product processes from ordering to assembly: a set tailored to individual needs and requirements can be assembled from all the required components in just a few steps. No electrician required for installation. The engaging plug connections are protected against polarity reversal and the solutions can be upgraded easily by means of modular extension kits, for example with an IO module.

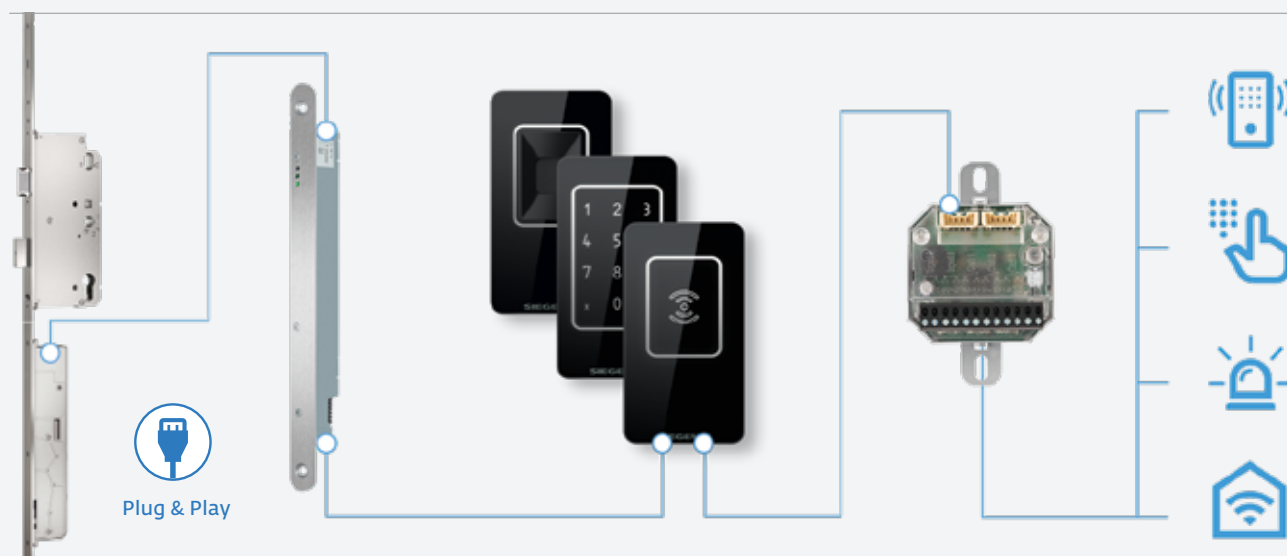

Production benefits

- Snap-in plug connections, protected against polarity reversal: no electrician required
- Modular extensions are possible
- Sash-side or frame-side installation of the access control systems possible

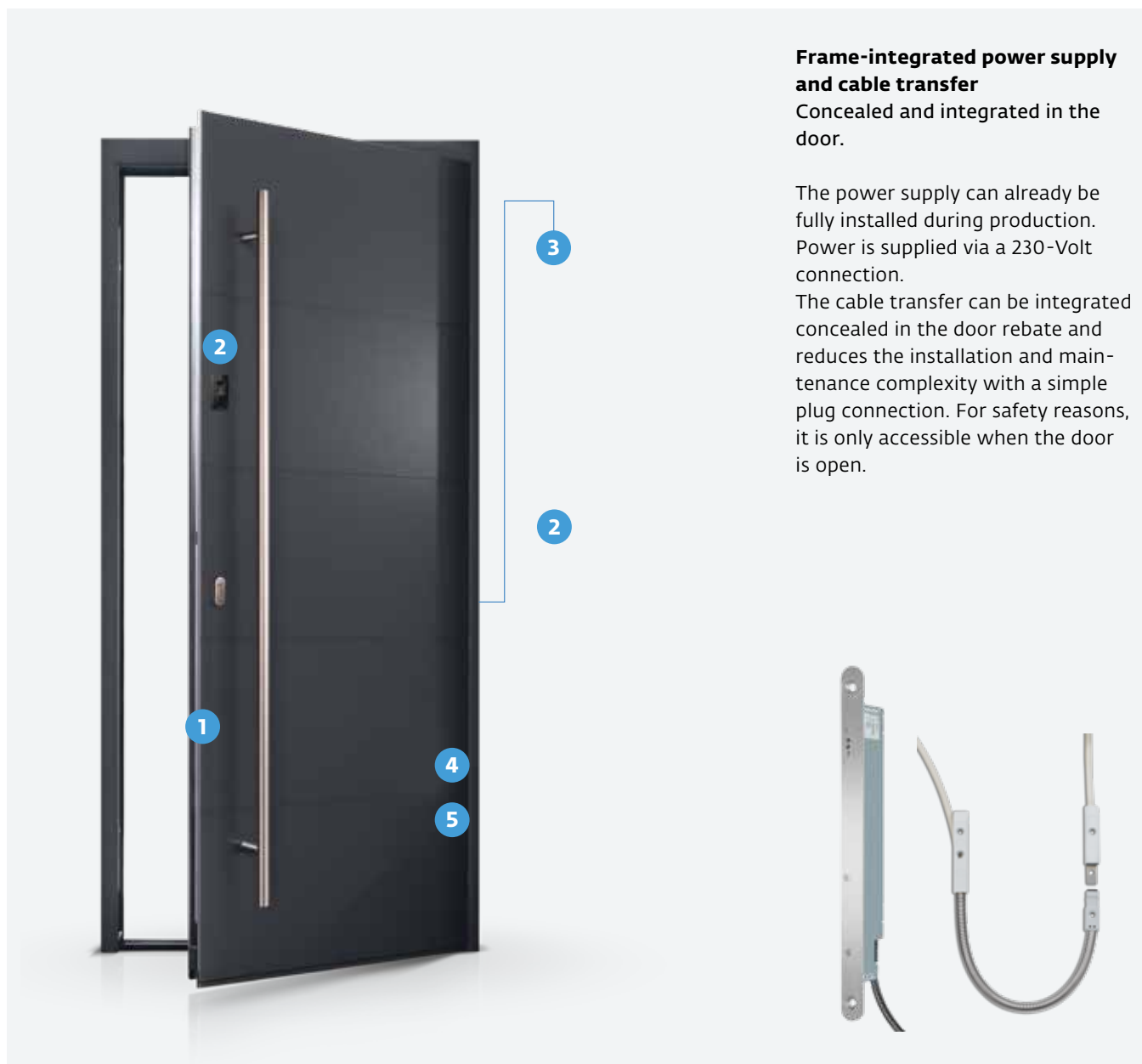

Frame-integrated power supply and cable transfer

Concealed and integrated in the door.

The power supply can already be fully installed during production. Power is supplied via a 230-Volt connection.

The cable transfer can be integrated concealed in the door rebate and reduces the installation and maintenance complexity with a simple plug connection. For safety reasons, it is only accessible when the door is open.

- ❶ Multi-point lock with motor**
AS 2600 GENIUS 2.2
BS 3700 with A-opener 2.2
Motor

- ❷ Access control system**
Fingerprint scanner
Keypad
Transponder;
sash-side or frame-side
installation

- ❸ Extension**
IO module,
IO module smart

- ❹ Power supply**
❺ Cable transfer

Multi-point service locks

A quick solution for defective front doors independent of manufacturer.

The multi-point service lock is the ideal solution to quickly repair and maintain front doors for homes and apartments. As a manufacturer-independent system, it can cost-effectively replace a variety of key-operated and lever-operated multi-point locks. The multi-point service lock is available with comfort mushroom cam, H-bar, round bolt, hook bolt or round bolt-hook bolt combination. This is not offered currently by any other solution. Its strength is also verified in burglar resistance. This is proven by the successful test as a burglar resistant retrofit product in accordance with DIN 18104 – Part 2.

Production benefits

- Manufacturer-independent system for all conventional door heights from 1,625–2,400 mm
- Special flat coupling point in profile with U-faceplate with SIEGENIA TITAN AF fine interlocking reduces milling work
- As a rule, the faceplate is made of stainless steel for a high-quality appearance without corrosion on any cut edges
- Freely selectable handle positions
- Secondary sash set can be combined with key-operated or lever-operated main lock sets
- Main lock set is available with backsets of 25 - 80 mm, resulting in reduced warehousing
- DIN direction can be adjusted on site, smooth switch-over process
- Reduction bush of 10 to 8 mm square included in the key-operated variants of the main lock set as standard
- Special versions of the faceplate centre section with 90 or 100 mm backset available

Set of faceplates

The set of faceplates includes a top, centre and bottom part for variants with an auxiliary lock case. In this case, a selection can be made between H-bolt, round bolt, hook bolt or a round bolt-hook bolt combination. A variant with a comfort mushroom cam is also available. Coupling with the centre part is accomplished with the especially flat coupling point with fine interlocking.



Main lock set

The key-operated and lever-operated main lock sets are available in many backsets. The key-operated versions are equipped with maintenance-free soft lock latches and a reduction bush of 10 to 8 mm square lever.



Possible with all lock types

The multi-point service lock is available with comfort mushroom cam, H-bar, round bolt, hook bolt or round bolt-hook bolt combinations and for all conventional door heights.





Locks

Solid solutions for all materials.

For all requirements.

We offer a large range of mortise locks, latch and deadbolt locks and special locks for residential and commercial buildings. You are sure to find the right lock here: for interior doors in homes or public buildings, for initial equipment or for subsequent installation.

In all lock classes.

Besides special dimensional specifications, DIN 18251 Part 1 also lays down quality demands for locks, by definition of different classes with regard to the intended purpose. Whatever class of lock you need: with KfV, you will find what you are looking for.

Class 1: for doors that are opened infrequently and carefully: for example, storeroom doors.

Class 2: for doors that are opened regularly and carefully: for example, office doors.

Class 3: for doors that are opened frequently and with great force: for example, doors in public buildings.

Class 4: for doors that are opened very frequently and sometimes roughly: for example doors with increased burglar resistance and doors in public buildings.



Almost too beautiful to close.

With the magnetic lock, the latch lies flush in alignment with the gear box when the door is open. It is pulled into the frame part by neodymium magnet technology only when the door is closed. In addition to achieving the highest design standards, this also improves the locking action.

Mortise locks and magnetic locks

For timber doors.

Mortise door locks

More options for all requirements.

With our great spectrum of high-quality mortise locks in accordance with DIN 18251, you will always have a solution on hand, which is perfectly matched to the respective frequency of use and security requirements - from doors in private homes to doors in public buildings. Of course, KfV mortise locks are also available for rebated doors or flush doors that close using skeleton keys, bathroom locks or cylinders. They are suitable for initial equipment as well as for uncomplicated retrofitting.

Magnetic locks

Streamlined appearance with whisper-quiet locking comfort.

The magnetic latch is mounted flush in the gear box in our innovative magnetic locks. The latch only extends into the frame part and is secured in place by magnetic force when the door is fully closed. In this way it does not knock against the door frame and ensures whisper-quiet and enhanced locking comfort as well as perfect design. The durable system is maintenance-free and remarkably wear-resistant.

Production benefits

- Certified mortise locks in accordance with DIN 18251 for residential, commercial and government buildings
- Durable technology thanks to consistently high quality
- Comprehensive product range with diverse customised solutions
- Individual door design due to different faceplate finishes

Mortise door locks	104-1/2-BB	114-1/2-PZW
	Mortise lock for interior doors in accordance with DIN 18251-1 Class 1	Mortise lock for doors in accordance with DIN 18251-1 Class 2
Door profile	Timber	Timber
Interior / room doors	⊙	⊙
Entrance doors and side entrance doors		
Special features		



Mortise locks in accordance with DIN 18251 up to class 4

Magnetic lock 116 for flush-closing doors



113-1/2-PZW

Mortise lock for doors in accordance with DIN 18251-1 Class 3

1133-1/2-PZW

Mortise lock for doors in accordance with DIN 18251-1 Class 3

63-1/2-PZW

Mortise lock for doors in accordance with DIN 18251-1 Class 4

116

Magnetic mortise lock for interior doors

Timber	Timber	Timber	Timber
⊙	⊙	⊙	⊙
⊙	⊙	⊙	
	Particularly suitable for use in public buildings	Particularly suitable for use in public buildings; enhanced burglar resistance	Flush design when door is open, quiet and wear-free, stainless steel, matt brushed or painted white or black

Latch and deadbolt locks

For PVC and metal doors.

Our extensive selection of high-quality latch and deadbolt locks in accordance with DIN 18251-2 or EN 12209 opens up versatile solutions for numerous profile situations. KfV latch and deadbolt locks are available with single turn or double turn, with different deadbolt projections, various backsets as well as different faceplate variants and surface finishes. They are suitable for initial equipment as well as for uncomplicated retrofitting.

Production benefits

- Tested latch and deadbolt locks in accordance with DIN 18251-2 or EN 12209 for residential, commercial and government buildings
- Durable technology thanks to consistently high quality
- Single turn or double turn with deadbolt secured against sawing
- Extensive product range: diverse backsets (18–65 mm) and faceplate variants as well as different deadbolt projections (15, 20 and 25 mm)
- Individual door design due to different faceplate finishes
- Many customised solutions

Latch and deadbolt locks	28-PZW	49-PZW	59-PZW
	Latch and deadbolt mortise lock for doors in accordance with DIN 18251-2 Class 1	Latch and deadbolt mortise lock for doors in accordance with DIN 18251-2 Class 3	Latch and deadbolt mortise lock for doors in accordance with EN 12209 2S800C4*BC20
	Metal, PVC	Metal, PVC	Metal, PVC
	⦿	⦿	⦿
	⦿	⦿	⦿
Door profile	Metal, PVC	Metal, PVC	Metal, PVC
Interior / room doors	⦿	⦿	⦿
Entrance doors and side entrance doors	⦿	⦿	⦿
Special features	Deadbolt, single turn, 15 mm deadbolt projection	Deadbolt, single turn, 20 mm deadbolt projection	Deadbolt, double turn 25 mm deadbolt projection

* in conjunction with protected striker plate lock case



Latch and deadbolt mortise locks
up to 25 mm bolt projection



Special locks for special applications.

The unique KfV product range offers you the maximum range of solutions in the area of special applications. Here you will always find the right solution for your special requirements, for example locks for sliding doors with hook bolts or radius bolts and locks for radiation protection doors. This is supplemented by a range of further locks for fire protection doors.

Diverse versions for a wide range of application areas

Steel doors
Radiation protective doors
Sliding doors
Swing doors

Swing door roller latch
Deadbolt lock



Deadbolt lock



Roller bolt lock





Sliding door lock



Sliding door lock



Lock for
radiation protective door





Emergency exits and panic locks

Reliable solutions in accordance with EN 179 and EN 1125 with maximum efficiency and functional safety.

The complete panic range.

Our complete range of locks and multi-point locks offers various tried-and-tested solutions for fire rated doors, emergency exit locks in accordance with EN 179, and panic door locks in accordance with EN 1125. These stringently tested lifesavers can be operated intuitively, but also fabricated very easily and efficiently. We have revolutionised the fabrication processes for double-sash panic exit doors with an assembly-friendly three-part solution, for which the innovative driving rod technology minimises the milling expenditure for the panic secondary sash lock bolt as well as the total production time.

Locking functions B, D and E.

Locks and multi-point locks for escape doors can be opened in the direction of escape without a key at any time, even when they are locked. After the escape function has been used and the door has been closed, either access in the opposite direction to the direction of escape is blocked or it is possible to escape back through the door.

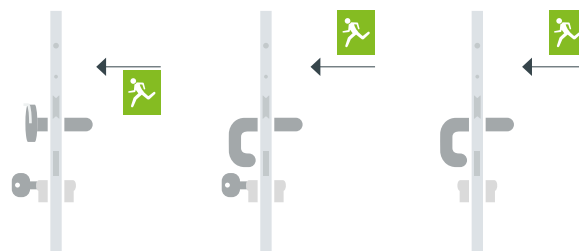

Solutions for escape doors and emergency exit doors

Reliable systems for single or double-sash escape doors, smoke and fire protection.

All multi-point locks and special locks from the comprehensive KfV panic range provide stringently tested and flexible solutions, which are distinguished by maximum functional security and intuitive operation. As every second counts, not just in an emergency, but also during fabrication, the multi-point locks for all escape door functions are based on the same main lock families and on auxiliary lock cases with identical dimensions. The DIN direction can be adjusted easily using the latch. The direction of escape can be set on the main lock for locking functions B and D.



The use of these locking components is only permissible in conjunction with mutually tested and certified hardware. EN 179 in combination with door lever handles, EN 1125 in combination with horizontal actuating bars!

Multi-point locks for escape doors

	EP 960 Panic locking part in accordance with EN 179 and EN 1125	GEP EP 960 Electromechanical locking part in accordance with EN 179 and EN 1125
Locking type	Round bolt-hook bolt combination	Round bolt-hook bolt combination
Door height can be extended	up to 3,000 mm	up to 3,000 mm
Intended for resistance class in accordance with EN 1627–1630*	up to RC3	up to RC3
Fire-rated doors	⊙	⊙
Emergency exit and panic doors	⊙	⊙
Latch changeover (DIN right/left adjustable)	⊙	⊙
Direction of escape can be adjusted	⊙	⊙
Locking rail with adjustment option +/- 2.5 mm	⊙	⊙
Individual striker plates with adjustment option +/- 2.5 mm	⊙	⊙
Secondary sash lock bolt for double-sash Front doors	⊙	⊙

Options for greater room comfort

Soft lock latch	optional	optional
Day latch	⊙	⊙
Bolt switch contact control system	⊙	⊙
Access control systems	—	⊙
Concealed axxent door hinge	⊙	⊙

* The hardware must be protected against manipulation from the outside.



Time-saving in case of emergency and in production

- Modular structure with uniform routing templates and screw positions
- Extremely simple assembly due to omission of threaded rods
- DIN direction and escape side for function B can be individually adjusted
- Diverse backsets and PZ dimensions available
- All locks and multi-point locks can be universally used for EN 179 and EN 1125 and can be delivered in locking functions (B, D or E)
- Solutions for all conventional secondary sash profiles in timber, PVC or metal for door elements with an overall height up to 3,000 mm
- When the inactive sash of a double-sash escape door is opened, the main sash also automatically unlocks, freeing the entire escape route
- KfV GENIUS PANIC GEP: automatic locking and release, locking functions B and E possible

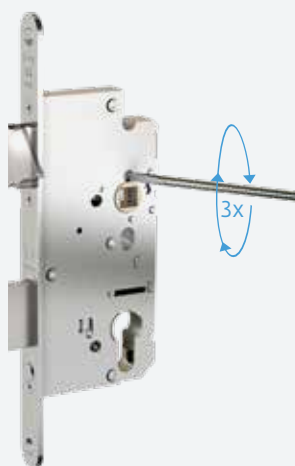

Locks for escape doors

EP166

Panic mortise lock for emergency exit and panic doors in accordance with EN 179 and EN 1125

EP99

Panic deadbolt mortise lock for emergency exit and panic doors in accordance with EN 179 and EN 1125

Door profile	Timber	Metal, PVC
Interior / room doors	⊙	—
Entrance doors and side entrance doors	⊙	⊙
Fire-rated doors	⊙	⊙
Emergency exit and panic doors	⊙	⊙



Frame parts

The optimum frame range for all materials and profile systems.

Efficient versatility.

You will also benefit in several ways with our frame parts: because for KfV, not only every lock and every multi-point lock, but also every frame part belongs to a modular system concept – with freely combinable product families, clever uniform dimensions and real innovations. With few component designs and without special frame parts, this offers a maximum diversity of solutions, simple work steps and minimum warehousing.

Practical innovations.

The eccentric compression adjustment with its unique adjustment range of ± 2.5 mm at a low installation depth is the best on the market. This simplifies the installation and provides very high compression for protection against gusts of wind and driving rain. Our frame parts with compression adjustment can be used with all multi-point lock types with round bolts, hook bolts (6 mm / 8 mm) or round bolt-hook bolt combinations. An appealing appearance and easy assembly are ensured by the profiled and easily positioned end caps and the deadbolt lining, which completely conceals the punched hole and can be conveniently inserted from the front.



Simple installation.

- ❶ Pressure adjustment: optimum compression and best tolerance compensation.
- ❷ Deadbolt lining: can be conveniently applied from the front and is available in various installation depths.
- ❸ Profiled end caps: for correct positioning and an elegant appearance with various PVC profiles.

Individual striker plates and locking rails

Maximum solution variety in a modular system.

Individual striker plates

The high-quality solution for all lock designs.

With these high-quality individual striker plates, you have a visually appealing and universally applicable solution for all lock types at hand with just one design, which can be optimally fabricated and flexibly adjusted by means of numerous innovations.



locking rail

More stability and security in a continuously elegant appearance.

This sturdy locking rail, which can be used for different lock versions, increases the security and enables an uninterrupted frame part design. The assembly is improved as only one part is fixed. What's more, you also benefit from all the advantages provided by the individual striker plates.



Production benefits

- Easy to install and cost-effective
- One variant for all locking parts
- Continuous compression control of the main lock latch via the AT piece
- Deadbolt lining in various installation depths: can be inserted from the front
- Auxiliary lock case: perfect tolerance compensation with eccentric compression control for round bolts and hook bolts of +/- 2.5 mm
- Profiled end caps for easier positioning

Production benefits

- Easy installation, as only one part needs to be fixed
- One variant for all locking parts
- With chamfer and continuous compression control of the main lock latch provided by the AT-piece
- Perfect tolerance compensation: with eccentric compression control of +/- 2.5 mm for round bolts and hook bolts
- Deadbolt lining in various installation depths: can be inserted from the front

Double-sash doors

More quality with ease from secondary sash to bottom keep.

Secondary sash lock bolt

More comfort and efficiency for high-quality inactive sashes.

KFV secondary sash lock bolts combine security and a clear design with efficient assembly and stock-holding. Convenience is also a top priority here. For example, the T-handle for the BS80 automatically protrudes at the push of a button, facilitating locking and unlocking. Fully flush when not in use, the system is also easy to clean.



Bottom keep

Less friction and considerably less tolerance sensitivity.

With its generous compression adjustment of +2 to -1 mm, this bottom keep compensates installation tolerances very flexibly and simplifies operation of the shoot bolt long-term due to minimum friction.



Production benefits

- For the inactive sash of double sash entrance doors
- Available for right or left side installation according to the DIN direction of the active sash
- Can be combined with mechanical and electromechanical KFV multi-point locks

Production benefits

- Optimally aligned with the KFV secondary sash hardware and shoot bolt
- Compression adjustment from +2 to -1 mm for optimum compensation of installation tolerances
- Compensation rings available in inclines of 5° and 9° for adaptation to thresholds

Accessories for the frame

For individual security, comfort and design requirements.

Bolt switch contact

Integrate VdS tested entrance doors into alarm systems.

With the bolt switch contact, entrance doors can be connected to an alarm or monitoring unit to control the open or locked status of the door. The system is invisible from the outside, certified in accordance with VdS Class C and wear-free because it functions without contact.



Frame parts with reinforcement plate

Special versions for higher stability.

A significantly greater burglar resistance is achieved due to the reinforcement plates with screw into the lining as well as partially into the masonry.



Day latch

Release of the main lock latch so you can leave the house without a key.

With the KfV day latch, you can easily release the main lock latch by means of a mechanical locking mechanism via a locking slider to leave the house for a short period without using a key. Because doors that appear to be closed can be opened simply by "pushing" on them.



Production benefits

- Quick and easy installation in the locking rail or striker plate
- Replaces the Q adjustment, its adjustment range is retained
- Can be connected individually, in series or parallel
- For all KfV multi-point locks with hook bolt
- Also suitable for escape doors
- Special version for BS 3700 in preparation (Q3/2025)
- Easily adjusted at any time

Production benefits

- Available for apartment building entrance doors with lining and cladding of different door systems in the various size variants
- For example, can be used as a latch or deadbolt plate or as a hinge side security device

Production benefits

- For locking rails and striker plates with E-opener cut to length
- More cost-effective than an E-opener
- Quick and easy to install and can be adjusted even after installation
- For retrofit or for standard use with KfV frame parts
- Low installation dimension
- Can be used DIN right and DIN left

Hinge side security device

More burglar resistance for all-round secure doors.

Our KfV hinge side security devices offer effective and extremely easy-to-install solutions for increased burglar resistance. The interlocking teeth of the two wedge locking elements eliminate potential points of attack by making it virtually impossible to prise the door open, even on the hinge side. These additional security devices can be adapted to the airgap of the respective profile system.



Production benefits

- For timber, PVC or aluminium doors
- Quick and easy to install
- Consisting of two uniform, toothed wedge lock elements
- Can be flexibly adapted to the airgap of the respective profile system.

axxent door hinge

The fully concealed hinge side for modern aluminium doors in a perfect design.

The design is elegant and timeless, but the assembly is quick and easy. The fully concealed assembly makes aluminium doors into discreet elements of design, thereby supporting the achievement of high-end living concepts. As a two-part design, only one person is needed to hang or lift-off the door sash and there is complete freedom for lateral, height and pressure adjustment.



Production benefits

- For aluminium doors up to 120 kg
- Readily accessible 3D adjustment with large adjustment ranges for very flexible lateral, height and pressure adjustment
- The two-part hinge with frame and sash part makes it particularly easy to hang and lift-off the door leaf
- Low level of profile milling required

SIEGENIA®

brings spaces to life

Head Office:
Industriestraße 1–3
57234 Wilnsdorf
GERMANY

Phone: +49 271 3931-0
Telefax: +49 271 3931-1333
info@siegenia.com
www.siegenia.com



You can find address details for our
international sites at: www.siegenia.com

SIEGENIA worldwide:

Austria Phone: +43 6225 8301
Benelux Phone: +31 613 143773
China Phone: +86 316 5998198
France Phone: +33 3 89618131
Germany Phone: +49 271 39310
Great Britain Phone: +44 2476 622000
Hungary Phone: +36 76 500810

India Phone: +91 124 4121647
Italy Phone: +39 02 9353601
Poland Phone: +48 77 4477700
Russia Phone: +7 495 7211762
South Korea Phone: +82 15445369
Switzerland Phone: +41 33 3461010
Turkey Phone: +90 216 5934151
Ukraine Phone: +38 050 386 2718

Contact your distributor: